

MV-RD25DC

Eco Vandal Resistant Dome Camera's



Our discreet Eco vandal domes are the ideal low-cost solution for retail applications. They can be easily mounted on the wall or the ceiling and come with an optional Quick Install Pipe that reduces installation time to a minimum.



MV-RD25-DC

Flush mount made easy with the extending locking arms

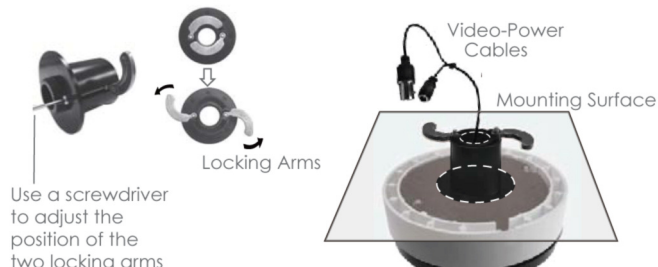
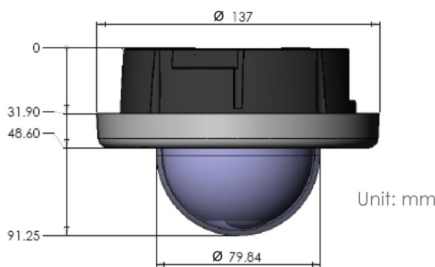

Use a screwdriver to adjust the position of the two locking arms

AVE (Europe, London)
Endeavour House,
Coopers End Road,
Stansted,
Essex, CM24 1SJ

Tel: +44 (0)845 600 9323
Fax: +44 (0)845 600 9363
Email: avesales@ave-uk.com
Web: www.ave-uk.com

AVE (Europe, Dublin)
123 Millennium Business Park
Ballycoolin
Dublin 11
Rep. Of Ireland

Tel: +353 (1) 8647450
Fax: +353 (1) 8647451
Email: avesales@ave-europe.eu
Web: www.ave-europe.eu

AVE (USA, Texas)
2501 Central Parkway, Suite C1
Houston,
Texas TX 77092

Tel: 281-443-2300
Fax: 281-443-8915
Email: sales@aveusa.com
Web: www.aveusa.com

Features

- Polycarbonate vandal resistant dome
- Built to IP66, impact protection >IK10+3
- Surface or flush mount
- 500 TV Lines.
- 1/3" Format CCD.
- Sony SS11X DSP.
- 0.6 Lux @ F1.2.
- 4~9mm DC Iris lens.
- 3-axis gimbal.
- Operates on 12VDC
- Quick Install Pipe (Optional)

General Specifications

Material	UV stable polycarbonate material for base, shroud and bubble
Bubble	Clear bubble with liner (tinted bubble also available, terms apply), elongated to support 90 degree rotation
Gimbal	3-axis ratchet gimbal
Integrity	IP66 Vandal Resistant with Security Torx screws
Impact Protection	Rating Exceeding IK10+3 (120J)
Fixing	Surface or flush mount Supports direct mount to US single gang box mount Supports direct mount to UK metal electrical box
Lens type	4-9mm F1.6 AI/AF lens
Resolution	500 TVL with basic 2 dip function for AGC & BLC
Image size	1/3" Interline CCD sensor. 752H x 582V pixels
DSP	Sony SS11X
Sensitivity	1.2Lux @F1.6
Voltage	12VDC ±15% only
Operating Temp.	-10°C~+50°

Lens Specifications

Type of Focal	Varifocal, 4.0~9.0mm
Type of Iris	DC Drive Auto-Iris
Iris Range	F1.6 ~ 360
Field of View	Diagonal: 92.8°~39.4°
Horizontal:	71.0°~31.6°
Vertical:	51.6°~23.6°
Minimum Object Distance	0.15m
Lens Type	Aspherical

Quick Install Kit MD-QIP (Optional)

Installer friendly.
Universal ceiling/wall mount.
Reduces installation time to a minimum.